

iQ500, Built-in washing machine, 8 kg, 1400 rpm WI14W301GB



iSensoric fully integrated built-in washing machine with iQdrive and very high energy efficiency.

- ✓ iQdrive motor: Intelligent, quiet, and durable with warranty
- ✓ waveDrum for highly effective and extremely gentle laundry care.
- ✓ Lifetime protection against water damage -#quaStop®
- ✓ LED touch display shows all relevant information clearly and is easy to use

Features

Technical Data

Energy Efficiency Class (Regulation (EU) 2017/1369): C
 Weighted energy consumption in kWh per 100 washing cycles of eco 40-60 programme (EU 2017/1369): 62
 Maximum capacity in kg (EU 2017/1369): 8.0
 The water consumption of the eco programme in liters per cycle (EU 2017/1369): 45
 Duration of eco 40-60 programme in hours and mins at rated capacity (EU 2017/1369): 3:16
 Spin-drying efficiency class of eco 40-60 programme (EU 2017/1369): B
 Airborne acoustical noise emission class (EU 2017/1369): A
 Airborne acoustical noise emissions (EU 2017/1369): 66
 Construction type: Built-in
 Height of removable worktop (mm): 820
 Dimensions of the product (mm): 818 x 596 x 544
 Net weight (kg): 71.874
 Connection rating (W): 2300
 Current (A): 10
 Voltage (V): 220-240
 Frequency (Hz): 50
 Approval certificates: CE, VDE
 Length of electrical supply cord (cm): 210
 Door hinge: Left
 Wheels: No
 EAN code: 4242003865811
 Installation type: Full-integrated

Optional accessories

WZ20441
 WZ10131 Extension for cold water inlet /AquaStop
 WX975600 Floor securing component



iQ500, Built-in washing machine, 8 kg, 1400 rpm WI14W301GB

Features

Performance

- Energy Efficiency Class¹: C
- Energy² / Water³: 62 kWh / 45 litres
- Load capacity: 1 - 8 kg
- Programme duration⁴: 3:16 h:min
- Spin drying efficiency class: B
- Spin speed^{**}: 400 - 1400 rpm
- Noise level: 66 dB (A) re 1 pW
- Noise efficiency class: A

Programmes/functions

- Touch control buttons: Ready in, varioSpeed, start/pause with reload function, spin speed selection
- Special programmes: drain / spin, shirts/blouses, mixed fabrics, hygiene, rapid 15 minute quick wash, single rinse, handwash/wool, 30°C

Key features

- Reload Function: Stop the washing machine to add any forgotten items of laundry to the drum.
- waterPerfect Plus: for efficient use of water even with small loads thanks to intelligent sensor technology.
- antiVibration Design - for more stability and quietness
- EcoSilence drive with 10 year warranty

Additional features

- iQdrive with 10 year warranty
- Large display for programme progress indication, spin speed, remaining time, 24 hour end time delay and load recommendation.
- aquaStop: Siemens home appliance with lifetime warranty against water damage*
- Foam detection system
- Out of balance load adjustment
- Detergent dispensing: easy clean
- Divider for Liquid Detergent
- End of cycle buzzer
-

Technical Information

- Fully integrated
- Furniture door is reversible
- Dimensions (H X W X D): 81.8 x 59.6 x 57.4 cm
- Height adjustment with cardanDrive
- adjustable base height: 15 cm
- adjustable base depth: 6.5 cm

¹ Scale of Energy Efficiency Classes from A to G

² Energy consumption in kWh per 100 cycles (in programme Eco 40-60)

³ Weighted water consumption in litres per cycle (in programme Eco 40-60)

⁴ Duration of Eco 40-60 programme

^{**} Values are rounded.

* Please find warranty terms under: <https://www.siemens-home.bsh-group.com/uk/customer-service/warranty/additional-warranties>

iQ500, Built-in washing machine, 8 kg, 1400 rpm WI14W301GB

Dimensioned drawings

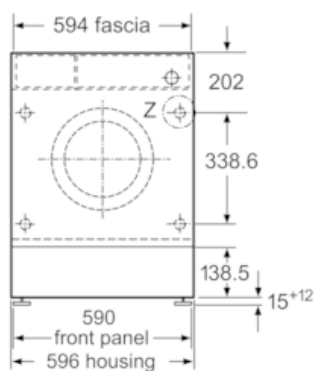

measurements in mm

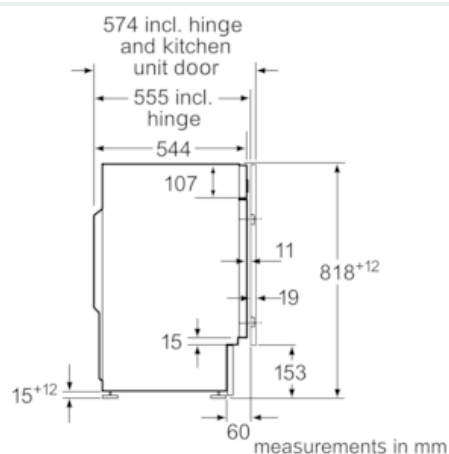

measurements in mm

Z detail

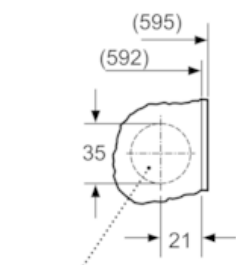

measurements in mm

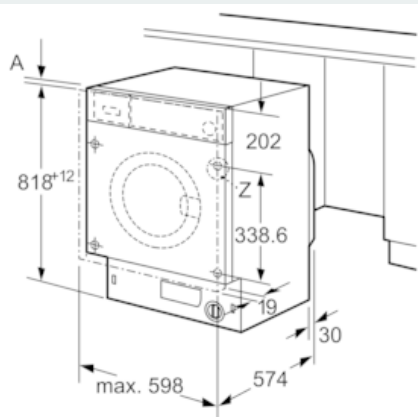

measurements in mm