

# Astbury Bridge

**Product Finish:** Pewter

**Product code:** AT3010

**EAN13 barcode:** 5060048383195



## Product features:

- Low lead brass construction
- Quarter turn handle action for precise flow control
- Victorian inspired aesthetic
- Supplied with adjustable centres 1/2" inlets, suitable for thicker worktops
- Antisplash spout supplied as standard

## Additional information / Parts included:

Cache key, allen key 2mm

## Packaged properties:

**Box length (mm):** 605 **Box depth (mm):** 85

**Box width (mm):** 320 **Units per outer:** 5

**Tap only weight (kg):** 2.38

**Boxed weight (kg):** 3.18

## Product dimensions:

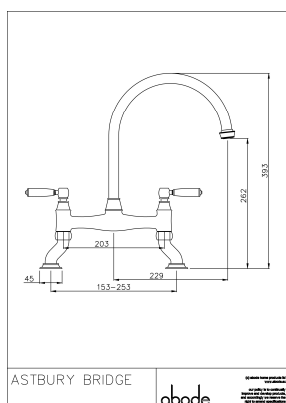

- **Overall Height / projection (mm):** 393
- **Exit reach (mm):** 229
- **Exit height (mm):** 262
- **Centre distance(s):** 203mm nominal +/- 50mm (153-253mm)
- **Base diameter(s) (mm):** 45
- **Recommended hole diameter (mm):** Ø 35
- **Max. surface depth (mm):** 85
- **Spout diameter (mm):** 20
- **Spout aerator size:** M20

## Product flow characteristics:

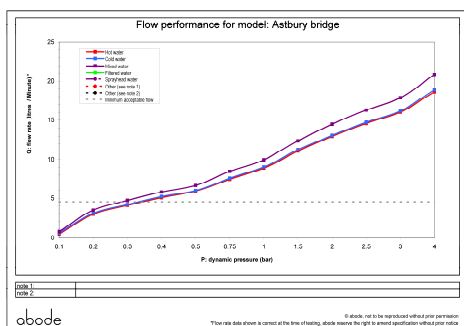

- **Min / Max water pressure (bar):** 0.40 / 5.5
- **Recommended / Max water temperature:** 46°C / 70°C
- **Part G - Mixed flow rate at 3 bar (litres / min):** 17.86
- **Control valve type:** Ceramic disc QT
- **Product flow characteristics:** Single flow
- **Non-return/Check valve(s):** Integral to H & C inlets
- **Aerator type:** Neoperl SLIM AIR CCSLC – STD flow class V
- **Accepts revolve / spray aerator:** No
- **Spout connection method:** Locking collar
- **Tail pipe inlet / outlet size:** 1/2" BSP Male / 3/4" BSP male
- **Inlet pipe type / length (mm):** fixed threaded inlets / 105

## Care instructions summary:

.Clean the product regularly using a mild washing up liquid, do not use any other cleaners.  
 .Regular cleaning will prevent the build up of lime scale and dirt  
 .After cleaning rinse thoroughly with clean water to remove any cleaner residue  
 .Residues of sink & worktop cleaners can also cause damage, so rinse with clean water after using, avoid contact with any abrasives

## Warranty Summary (Full details available on request):

.Materials and workmanship defects warranted for 5 years  
 .Valves and working parts warranted for 5 years  
 .Surface warranty defects warranted for 1 years  
 .O-rings, hoses & gaskets warranted for 1 years

abode