

Product Finish: Matt Black

Product code: AT2125
EAN13 barcode: 5060344158657



Note: the image shown may not reflect the product finish, chrome finish is typically depicted.

Product features:

Metal construction throughout

Supplied complete with flexible tail pipes for fast simple fitting

Quarter turn handle action for precise flow control

Antisplash spout supplied as standard

Subtle soft sweeping design form

Additional information / Parts included:

Product dimensions:

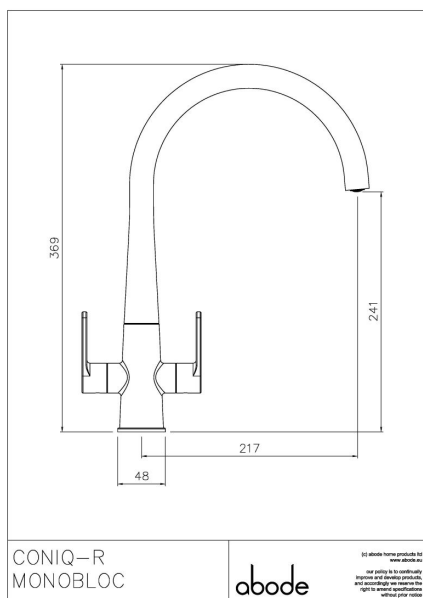

• Overall Height / projection: 369 mm

• Exit reach: 217 mm

• Exit height: 241 mm

• Centre distance(s):

• Base diameter(s): 48 mm

• Recommended hole diameter: Ø 35 mm

• Max. surface depth: 65 mm

• Spout diameter: 24 mm

• Spout aerator size: M21.5 x 1

Packaged properties:

Box length: 440mm

Box depth: 70mm

Box width: 340mm

Units per outer: 5

Tap only weight: 1.40kg

Boxed weight: 2.18kg

Product flow characteristics:

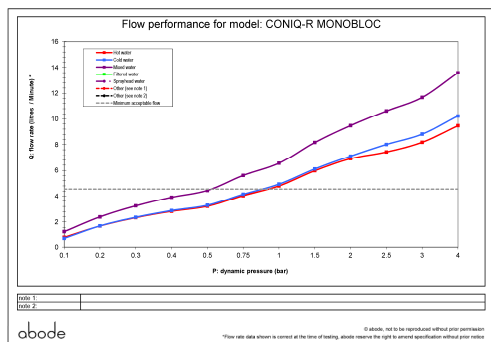

• Min / Max water pressure: 0.50 / 5.5 bar

• Recommended / Max water temperature: 46°C / 70°C

• Part G - Mixed flow rate at 3 bar (litres / min): 11.68

• Control valve type: Ceramic disc QT

• Product flow characteristics: Single flow

• Non return valve(s): Integral to hot & cold inlets

• Aerator type: Honeycomb coin slot aerator

• Accepts revolve / spray areator: No

• Spout connection method: Grub screw (2.5mm)

• Tail pipe inlet / outlet size: M10 / 1/2" BSP Male

• Inlet pipe type / length: Flexible stainless braided hose / 365 mm

Care instructions summary:

- Clean the mixers and showers regularly as required, using soap, do not use any other cleaners.
- Regular cleaning will prevent the build-up of lime scale and dirt
- After cleaning rinse thoroughly with clean water to remove any cleaner residue
- Residues of sink & worktop cleaners can also cause damage, so rinse with clean water after using, avoid contact with any abrasives

Warranty Summary (Full details available on request):

- Materials and workmanship defects warranted for 5 years
- Valves and working parts warranted for 5 years
- Surface warranty defects warranted for 1 year
- O-rings, hoses & gaskets warranted for 1 year