





Matrix R0 - 1.0 Bowl

Not handed - Stainless Steel

abode

 	Abode code:	AW5008
	EAN 13 Barcode:	5060048387438
	Specification version:	1
	Finish:	Brushed Finish

Included parts:				
 <p>1 x AX1001 (m) 90mm (1.5") Orbit manual basket strainer waste - short bolt</p>	 <p>1 x AX1102 (m) Rectangular overflow (90x30mm vertical)</p>	 <p>1 x AX1008-1 (m) 1 Bowl Pipework</p>	 <p>1 x AX4001 (m) Fitting & care instructions & data sheet - st/st undermount</p>	 <p>2 x AX1017 (m) Undermount fixing clips x 4</p>

Compatible parts / accessories:				

Packing summary: <ul style="list-style-type: none"> Packaging Type: Boxed Packaged size L x W x D: 565 x 500 x 290mm Boxed weight: 5.84kg 	Materials & workmanship warranty summary: <ul style="list-style-type: none"> Sink materials & workmanship 10 years. Waste kits 1 year. Connecting pipework 1 year. 	Care instructions summary: <ul style="list-style-type: none"> Clean the products regularly using soapy water and a non-abrasive cloth, regular cleaning will prevent the build-up of lime scale and dirt. Avoid contact with corrosive or abrasive substances. After cleaning rinse thoroughly with clean water then dry, for more detail see supplied booklet or www.abodedesigns.co.uk
---	--	--

Mounting Dimensions:						
Type of Installation:	Installation type recommended (true) or not?	Recommended minimum base unit mm (20mm wall thickness)	Overall recessed fitting width mm (required for bowl(s), tap hole, overflow)	Cut out size (length x width x corner radius mm)	Minimum - Maximum worktop thickness mm	Additional fitting notes
Inset			340		0 - 5	
Undermount	true	450	340	343 x 403 x R5		
Flushmount			340			
Apron front		450	340	343 x 403 x R5		

Product dimensions and installation information:



Note: symbol indicates position of acoustic pad on stainless steel sinks only
Overall product size: 380 x 438 x 205, 10mm corner radius



*Important, fabricator / installer notes for undermount & Flushmount sinks:

The cut out size indicated is aligned with outside edge of the bowl top radius (similar to the example below).

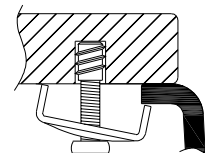

You should confirm with your client if the worksurface cutout is to be cut flush, inside or outside this suggested perimeter shape & size.

If you create the cutout smaller or larger than the indicated size then the fit of the accessories may be affected and should be physically checked.

General:

All details are provided in good faith but do not include the tolerances of the material or manufacturing process.

We request that a test cutout is made in scrap timber and checked against the actual sink to be installed before committing to cutting the final worksurface.

Abode can not accept liability for problems or costs incurred by failure to follow this request.

Note: the dimensions on ceramic fireclay products are subject to wider tolerances due to the nature of this natural material and the firing process.

CAD cutout files can be downloaded from www.abodedesigns.co.uk

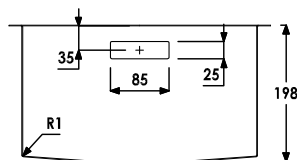
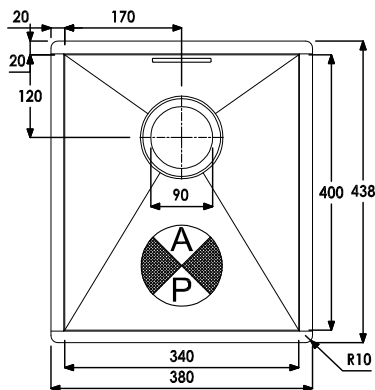

UNDERMOUNT CUT OUT

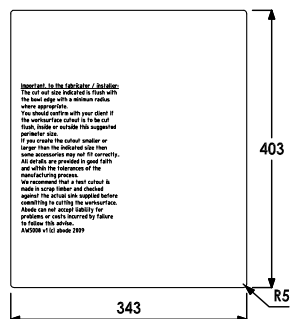

Additional notes:

Important: Please check cut out details carefully before cutting worktops, size shown is flush to bowl edge

Bowl & drainer details:	Bowl 1 (typically main bowl):	Bowl 2: (typically ½ or ¾ or 2nd main bowl):	Bowl 3:	Drainer (left)	Drainer (right)
Bowl Size Width x Length x Depth x Radius (mm)	340 x 400 x 198 x 1				
Bowl floor radius (mm)	1				
Wastehole diameter (mm)	90				
Overflow type	Rectangular flush				
Wall thickness (gauge mm)	1				
Bowl texture / finish	Brushed stainless				
Bowl volume (apx. litres)	21.2				