

KA-BV34PANEL-TO

Appliance Designation	Beverage Storage
GTIN	5061068710251
EEL Class	C
Rated EEL	124
Noise Level dB(A)	38dB
Noise Class	C
Rated annual energy consumption	104kWh/annum
Climate Class	SN/T - 16-38
Compressor	Inverter compressor
Refrigerant	R600A
Fan Assisted Cooling	Yes
Ventilation Required	Plinth ventilation essential
Temperature Range	2 to 14
Zone Type	1 zone
Defrosting Type	Automatic
Installation	Undercounter
Door	Technical door - panel ready
Door Handle	Push2open or with handle
Door Open Direction	RH hinged
Reversible Door	Yes
Door-Open Alarm Function	Yes
Lock	No
Capacity (L)	118L
Standard Storage Quantity	119 X 330mL cans
Shelves	2 glass shelves
Shelf Type	Telescopic
Light	Smooth strip LED - 3000k (dimmable)
Auto. Lighting Function	Yes
Control	LED touch display
Control Display Colour	White
Charcoal Filter	No
Softclose	Yes
Heating Ability	Yes
Internal Humidity	55-85% - automatic
Vibration Free	Yes
Power Lead Length	1.5m
Adjustable Feet	Yes - 70mm
Warranty	3 years P & L

Body Dimension / Weight

H820 x W595 x D577mm

48kg

Packing Dimension / Weight

H920 x W655 x D665mm

53kg

ENERGY LABEL

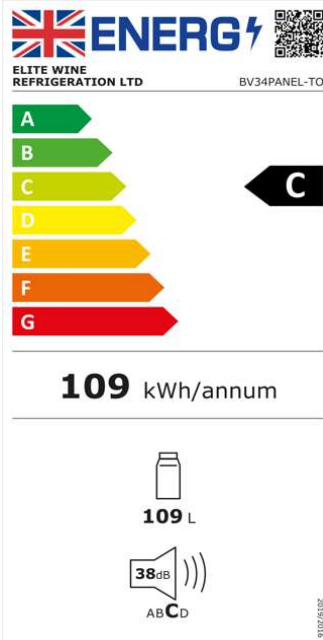

BOTTLE LOADING

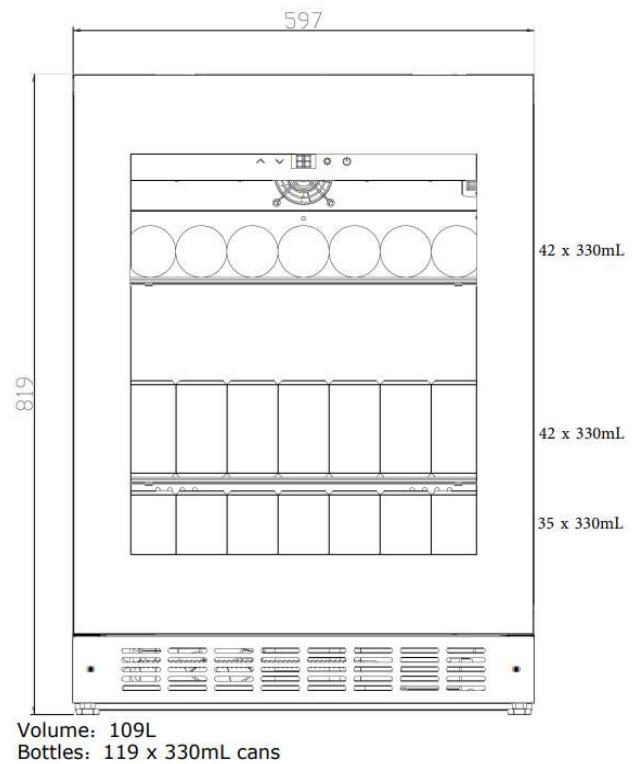
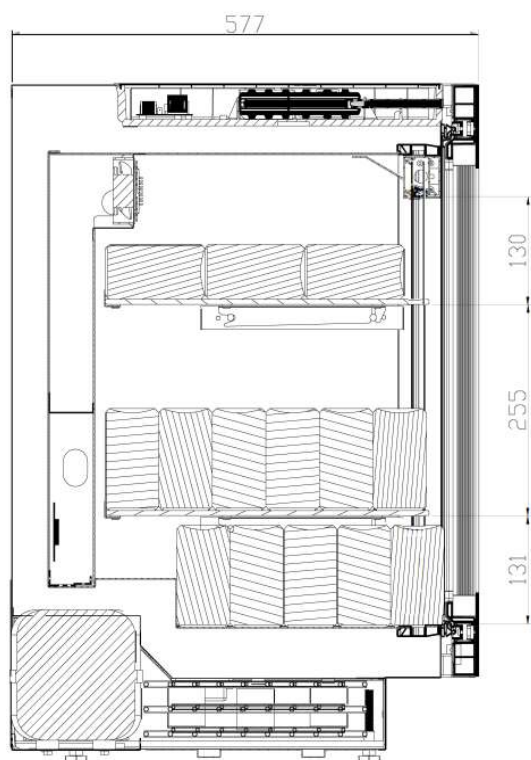

PLEASE NOTE - LARGER BOTTLES MAY REQUIRE A SHELF REMOVING AND THE STATED CAPACITY WILL DECREASE FROM 119 CANS

FURNITURE DOOR SPECIFICATIONS

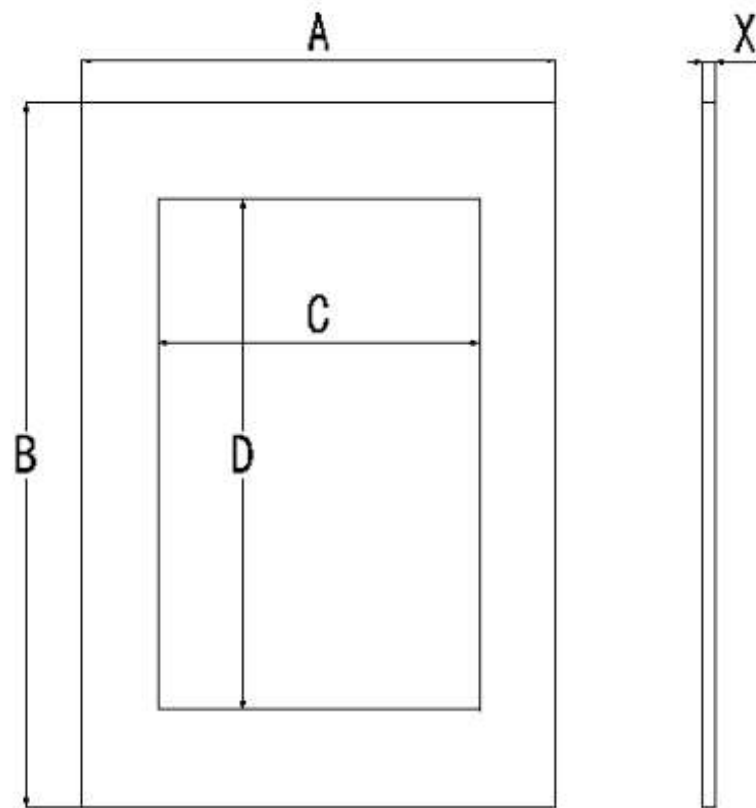

	A (mm)	B (mm)	C (mm)	D (mm)	X (mm)
W34PANEL-TO	595 max	715 min	415 min	515 min	13-22 max
BV34PANEL-TO	595 max	715 min	415 min	515 min	13-22 max

	Max Weight
W34PANEL-TO	14 kg
BV34PANEL-TO	14 kg

Please note the top and bottom bands are of equal heights with a minimum height of: 100mm

The side panels are also equal with a minimum width of: 90mm

INSTALLATION

PRODUCT DIMENSIONS

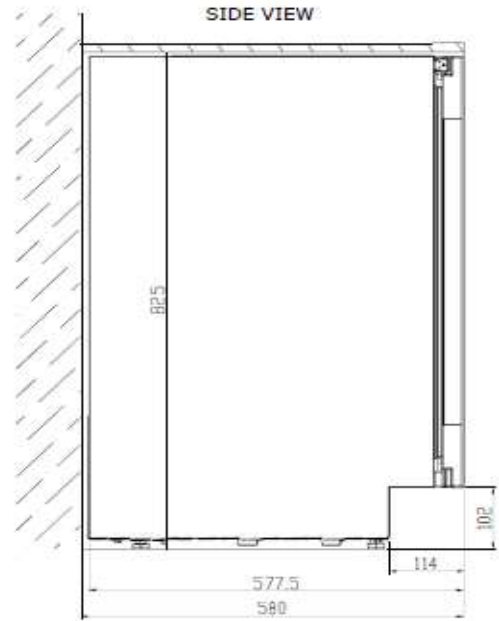
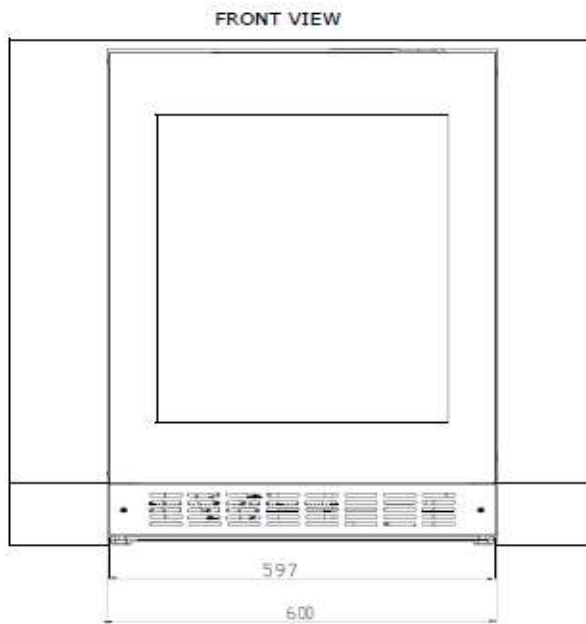

PLEASE NOTE - DIMENSIONS CAN VARY BY +/- 2mm DUE TO MANUFACTURING TOLERANCES, ALL DIMENSIONS GIVEN IN MILLIMETRES (mm)

NICHE DIMENSIONS

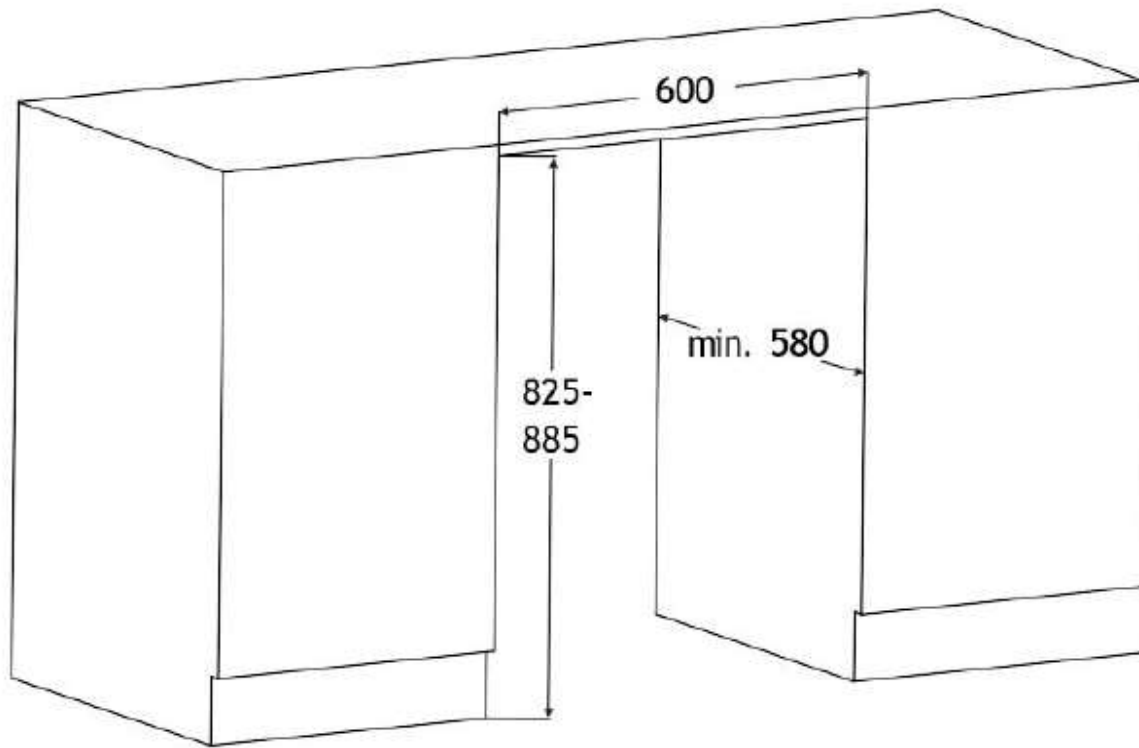

PLEASE NOTE - DIMENSIONS CAN VARY BY +/- 2mm DUE TO MANUFACTURING TOLERANCES, ALL DIMENSIONS ARE GIVEN IN MILLIMETRES (mm)